



Injectors

311 002 000

Fiat injector puller.

Special injector extractor suitable for JTD Diesel engines mounted on Fiat, Alfa, Lancia, Opel, Saab, Suzuki, Fiat injector puller models.

Models: Fiat, Alfa, Opel, Saab, Suzuki.

Engines: JTD



Injectors

311 064 000

Complete set for removing Delphi injectors on Ssangyong, Mercedes CDI, Kia and Mazda.

Models: Ssangyong & Mercedes.

Engine: CDI.

Models: Kia & Mazda.

Engine: Common Rail.

Components:

- Injector extractor
- Socket 21 mm - L=90 mm



Injectors

311 032 000

Special injector extractor suitable for Mercedes and Bosch models, complete with a Socket for dismantling electrical connection.

Models:

Mercedes: Sprinter, Vito, Viano, Vario.

Engines: CDI

Included Components

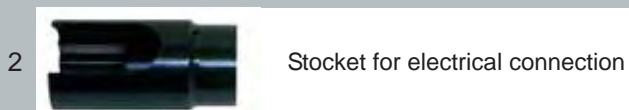

311 049 000

Complete set for removing Mercedes CDI injectors, specially designed for A & B - Class.

This tool enable to remove two injectors simultaneously without dismounting valves cover.

Models:

168 Mercedes A class (old model, up to 2004), 169 (245 B) Mercedes A class (new model, from 2004), Mercedes B class.

Engines: 668, 640



Injectors

NEW PRODUCT

Patent Pending

311 083 000

Complete set for removing Fiat 1.3 MJ injection nozzles.

This kit allows the removal of the tightly fixed injectors' nozzles, without dismounting the cylinder bearing. It is equipped with a "bridge system" and sliding bearing on it that grant a quick and easy injector's removal. The special screw has a double connection to fix inside and outside the injector.

Injectors: Bosch

Brand: Fiat & Lancia

Engines: 1.3 MultiJet 16v

Codes: 169A1.000-188A8.000-188A9.000-199A2.000-199A3.000-223A9.000

Brand: Alfa Romeo

Engines: 1.3 MultiJet 16v

Brand: Opel

Engines: 1.3 CDTI

Codes: Z13DTH - Z13DTJ - Z13DT

Brand: Suzuki

Engines: 1.3 DDiS 16v

Codes: Z13DT



Injectors

NEW PRODUCT

Patent Pending

Injectors

**311 026 000**

Universal complete set suitable for removing Bosch, Delphi: Mercedes, Volvo, Ford, Renault, Kia, trucks and general injectors.

Cassetta universale per l'estrazione degli iniettori.

Models: Mercedes, Volvo, Ford, Renault, Kia, Trucks.

Included components

- | | | |
|---|--|-------------------------|
| 1 |  | Body-tamper |
| 2 |  | M18 long handle 450 mm. |
| 3 |  | M18 long handle 350 mm. |
| 4 |  | Upper handle |
| 5 |  | Adaptor M18-M22 |
| 6 |  | M18 "Fork" extractor |
| 7 |  | Threaded insert |
| 8 |  | M18 Socket for Delphi |
| 9 |  | M22 Socket for Bosch |

Injectors

**311 062 000**

Special kit suitable for removing Siemens injectors on diesel engines (to apply to slide hammer code 311 026 000).

Engines: 1.4 - 2.0 - 2.2 diesel.

Models: Peugeot, Citroen, Ford, Toyota.

Components:

- 311026032 - Special Fork for Siemens injectors
- 311026033 - Special Socket M18-M25
- 311026034 - Locking nut.

Injectors

311 072 010

Socket for Simens Piezo M27x1 - M18x1,5, to use together with 311 026 000.

NEW PRODUCT

311 026 039

Universal joint to apply to slide hammer (code 311 026 000) in order to operate in case of few space condition.

Giunto snodato da utilizzare con estrattore a battitoio (codice 311 026 000).

Injectors



311 026 031

M18 socket suitable for Opel 2.2 Diesel models (to apply to slide hammer code 311 026 000).

Bussola M18 per iniettori montati su modelli Opel (da utilizzare con estrattore a battifio codice 311 026 000).

Injectors



720 019 000

Special socket for injector's electrical connection

Size: CH 29
Length: 78 mm
Connection: 1/2"



Injectors

NEW PRODUCT



720 020 000

Special socket for injector's electrical connection

Size: CH 30
Length: 78 mm
Connection: 1/2"



Injectors

NEW PRODUCT

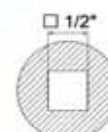

720 021 000

Special socket for injector's electrical connection

Size: CH 25
Length: 78 mm
Connection: 1/2"



Injectors

NEW PRODUCT

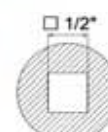

720 022 000

pecial socket for injector's electrical connection

Size: CH.27
Length: 78 mm
Connection: 1/2"



Injectors

NEW PRODUCT



720 023 000

Special socket for injector's electrical connection.

Size: CH.28
Length: 78 mm
Connection: 1/2"

Injectors

NEW PRODUCT

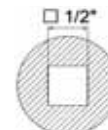

Injectors

311 055 000

Complete set for removing BMW Common Rail injectors, specially designed for M47TU, M57 and M57TU engines.

This kit allows the removal of tightly fit injectors nozzles without having to remove the cylinder head.

Engines:

Bmw Common-Rail M47TU, M57 and M57TU



Injectors

311 055 015

Complete set for removing BMW Common Rail injectors, specially designed for M47TU, M57 and M57TU engines. This kit allows the removal of tightly fit injectors nozzles without removing the cylinder head and the injectors seat cleaning thanks to the supplied blower.

Engines:

BMW Common Rail M47TU, M57 and M57TU.



311 056 000**Complete set for removing PSA HDI injection nozzles.**

This kit allows the removal of tightly fit injectors nozzles without having to remove the cylinder head. This kit is made of a pulling bridge that fits perfectly on PSA cylinder head, and with a special screw system allows a fast and easy nozzle removal.

Engines: PSA 2.0 (110, 135 HP) HDI DW10 and DW12 engines

**Injectors****311 056 014****Complete set for removing PSA HDI injection nozzles.**

This kit allows the removal of tightly fit injectors nozzles without removing the cylinder head.

It is equipped with:

- Pulling bridge that fits perfectly on PSA cylinder head
- Special screw system, that allows a fast and easy nozzles removal
- Blower to clean injectors seats.

Engines:

PSA 2.0 (110, 135 PS) HDI DW10 and DW12 engines.

Models: Bosch injectors, Siemens injectors.

**Injectors**

Injectors

311 050 000

Special injector extractor for injector Pump system. Complete with handle and slide hammer. Specially designed for Injector Pump system.

Models: VW injector Pump System.

Engines: TDI-PD



Injectors

311 050 006

Special injector extractor suitable for Volkswagen, Audi, Seat and Skoda models. Complete with handle, slide hammer and Special vice clip. Specially designed for Injector Pump system.

Models: VW injector Pump System and traditional injectors.

Engines: TDI-PD



311 072 000

Complete set for removing PSA HDI injection nozzles.

This kit allows the removal of the tightly fixed injectors nozzles without dismounting the cylinder head. It is equipped with a bracket and 6 special screws that grant a quick and easy injectors' removal. With this device injectors can be removed simultaneously.

Injectors: Bosch, Siemens

Brand: Peugeot, Citroen, Fiat and Lancia

Engines: 2.0 HDI, 2.2 HDI

Codes: RTH, RHW, 4HW, RHT, RHM, RHR, RHK

**Injectors****NEW PRODUCT**

Patent Pending

311 070 000

Complete set for removing Renault dCi injection nozzles. This kit allows the removal of the tightly fixed injectors nozzles without dismounting the cylinder head. It is equipped with a bracket and 2 special screws that grant a quick and easy injectors' removal. With this device the two injectors can be removed simultaneously.

Injectors: Bosch.

Brand: Renault

Engines: 2.0, 2.2, 2.5 dCi.

Codes: G9T, G9U.

Brand: Nissan

Engines: 2.2, 2.5 dCi.

Codes: G9T, G9U.

Brand: Opel.

Engines: 2.2, 2.5 dCi.

Codes: G9T, G9U.

**Injectors****NEW PRODUCT**

Patent Pending

NEW PRODUCT

Injectors

311 090 000

Complete set for removing Renault dCi and Master injection nozzles.

This kit allows the removal of the tightly fixed injectors' nozzles without dismantling the cylinder head. It is equipped with a bracket, 2 special screws that grant a quick and easy injectors' removal and a special support to use on Renault Master engines. With this device the two injectors can be removed simultaneously.

Injectors: Bosch

Brand: Renault dCi

Engines: 2.0, 2.2, 2.5 dCi

Codes: G9T, G9U

Brand: Nissan

Engines: 2.2, 2.5 dCi

Codes: G9T, G9U

Brand: Opel

Engines: 2.2, 2.5 dCi.

Codes: G9T, G9U



NEW PRODUCT

Injectors

311 090 001

Special body support, to use during Renault Master injectors' removal operations.

To use with 311 070 000.



NEW PRODUCT

Injectors

311 081 000

Special extractor specific for Denso injectors.

It is possible to use it together with 311 026 000, 311 070 000 and 311 072 000.

Application:

Toyota

Mazda

Hyundai

Engines: Common Rail



311 071 000

Complete puller suitable for Delphi injectors mounted on Renault 1.5 dCi engines.

Brands: Renault & Nissan

Engines: 1.5 dCi

Models: Delphi injectors



Injectors

NEW PRODUCT





Injectors

311 047 000 BOSCH

Set of tools suitable for Injectors seat cleaning, complete with:

- 311047013 - Special tool for injector seat resurfacing
- 311047003 - Special tool for injector edge resurfacing
- 311047005 - Special blowing tool (M10 + M8 thread)
- 311047008 - 17 mm. combination wrench

Models: Mercedes, Volvo, Ford, Renault, Kia, Fiat, Alfa, Lancia, Opel, Suzuki e VW.

Injectors: Bosch

Engines: CDI



Injectors

311 047 014 BOSCH & SIEMENS

Set of tools suitable for Injectors seat cleaning, complete with:

- 311047013 - Special tool for injector seat resurfacing (**Bosch models**)
- 311063000 - Special tool for injector seat resurfacing (**Siemens models**)
- 311047003 - Special tool for injector edge resurfacing
- 311047005 - Special blowing tool (M10 + M8 thread)
- 311047008 - 17 mm. combination wrench

Models: Mercedes, Volvo, Ford, Renault, Kia, Fiat, Alfa, Lancia, Opel, Suzuki e VW.

Injectors: Bosch

Engines: CDI

Models: Peugeot, Citroen, Ford, Toyota

Injectors: Siemens

Engines: 1.4, 2.0, 2.2 diesel



Injectors

311 047 017 BOSCH & SIEMENS

Set of tools suitable for Injectors seat cleaning, complete with:

- 311078004 - Special tool for injector seat resurfacing d.15,5 mm. (**Bosch models**).
- 311078005 - Special tool for injector seat resurfacing d.17-19 mm. (**Bosch models**).
- 311079004 - Special tool for injector seat resurfacing d.17 mm. (**Siemens models**).
- 311047003 - Special tool for injector edge resurfacing.
- 311080000 - Special blowing tool (M10 thread).
- 311047008 - 17 mm. combination wrench.

Models: Mercedes, Volvo, Ford, Renault, Kia, Fiat, Alfa, Lancia, Opel, Suzuki, VW.

Injectors: Bosch

Engines: CDI

Models: Peugeot, Citroen, Ford, Toyota

Injectors: Siemens

Engines: 1.4 - 2.0 - 2.2 diesel

311 063 003 SIEMENS

Special tool for injector seat resurfacing

Engines: 1.4 diesel.

Injectors



311 056 008 SIEMENS

Special tool for injector seat resurfacing

Engines: 1.4, 1.6, 2.0, 2.2 HDI

Injectors

NEW PRODUCT



311 047 016 BOSCH

Special tool for injector seat resurfacing d.15,5 mm.

Injectors

NEW PRODUCT



311 079 008 DELPHI

Special tool for injector seat resurfacing d.17 mm.

Injectors

NEW PRODUCT



311 047 018

UNIVERSAL



Special tool for injector edge resurfacing.

Injectors

NEW PRODUCT



311 078 000 BOSCH

Kit of tools for Bosch injector seat resurfacing.

Components:

311 047 003 - Special tool for injector edge resurfacing.

311 078 004 - Special tool for injector seat resurfacing d.15,5 mm.

311 078 005 - Special tool for injector seat resurfacing d.17-19 mm.

Injectors

NEW PRODUCT



311 079 000 SIEMENS & DELPHI

Kit of tools for Siemens and Delphi injector seat resurfacing.

Components:

311 047 003 - Special tool for injector edge resurfacing.

311 079 002 - Special tool for injector seat resurfacing d.17 mm (Delphi models).

311 079 003 - Special tool for injector seat resurfacing d.17 mm (Siemens models).

Injectors

NEW PRODUCT



311 080 000

Special blowing tool for injector seat.

Use this item together with 311 078 000 and 311 079 000.
Thread: M10

Injectors

NEW PRODUCT



Injectors

311 026 040



Special tool suitable to remove the injector spindle.
=> 10 mm.HEX

Attrezzo speciale per la rimozione e lo smontaggio dell'elettrodo degli iniettori.
=> 10 mm.

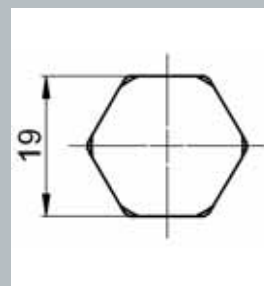

Injectors

311 076 000

NEW PRODUCT



Special tool suitable for extracting the seized copper sealing rings from the injector shaft.

With this extractor is possible to remove copper sealing without damaging the cylinder head. On the upper part, it is equipped with a performing slide hammer.



Injectors

311 051 000



Special injector extractor suitable for new generation Trucks that mount Injector-Pump system, and for traditional truck injectors. (Volvo, Scania, Mercedes, Man, Renault, Iveco, etc.).

